

PROBLEM: LAND — THE LIVING MEMORIAL. Mr. and Mrs. Cee lived in New Hartford for many years on a large tract of land. Both husband and wife spent many hours enjoying their land and maintaining it as an informal wildlife preserve. When Mr. Cee died, his widow decided to sell the house and improved portion of the land and move South for her health and to be near her children. But she kept the wildlife preserve intact. Mrs. Cee would like to guarantee that the land will be kept as it is to encourage continuation of the wildlife she and her husband both cherished. But now that she lives far from New Hartford she cannot keep an eye on the property, nor can she afford to arrange for professional management of her land. In point of fact, the rising cost of living has affected Mrs. Cee's income and she has been advised to sell the land. How can she attain her goal?

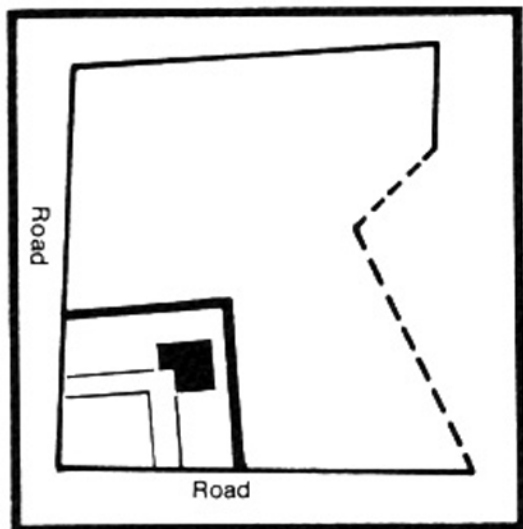

SOLUTION: The Land Trust makes it possible and practical to continue the preserve's existence and at the same time perpetuate her husband's memory in an appropriate manner. By giving the land to the Land Trust for permanent protection, the very land which had been an expense now becomes a source of income. Mrs. Cee's tax situation makes it possible for her to take full advantage of the appreciated value of the land and to make a substantial saving in income taxes.

The high valuation of the land could have made estate and inheritance tax problems for her children. Instead, as a nature sanctuary, the land becomes a permanent living memorial to Mr. Cee, and in a sense is a gift to the town from a family who had appreciated and worked to maintain New Hartford's rural atmosphere.

HOW TO PUT THE NEW HARTFORD LAND TRUST TO WORK

The total usefulness of the Land Trust depends entirely on the activity of those who support and use it. There are no paid Directors or Officers. There is no selfish interest. Every dollar contributed, and every acre of land donated, works for New Hartford. Whether or not you own open space land, you can use the Land Trust to help conserve open spaces and contribute to the beauty, orderly growth and the economic well-being of the whole community.

The New Hartford Land Trust is at your service!

IF YOU DO OWN OPEN SPACE LAND

If your land holdings include desirable open acres — consider how these acres may be used to increase the value of your property and protect the value of the total town.

Your contribution is not only tax-deductible — it helps to guide the growth of the town and guard your local tax rate. The added beauty and charm of open spaces tend to support the value of your holdings by making New Hartford a more desirable place in which to live.

We wish to express our appreciation to the many who have already supported our Land Trust by gifts of land, money or securities.